



**Transport**  
State Transit

# **OPERATIONAL ARRANGEMENTS**

## **Spring Cycle**

**Sunday 18 October 2015**

# Spring Cycle

## Sunday 18 October 2015

### 1. INTRODUCTION

#### 1.1 GENERAL OUTLINE

## 2 ROAD CLOSURES & SPECIAL EVENT CLEARWAYS

### 2.1 ROAD CLOSURES

Roads will be progressively reopened by the Transport Management Centre and NSW Police Force after cleaning.

#### **NORTH SYDNEY**

*From 4am to 11am*

- Angelo Street between McLaren Street and Berry Street
- Arthur Street between Berry Street and Mount Street
- Berry Street \*1 between Pacific Highway and Arthur Street North
- Bullivant Lane from Berry Street
- Carlow Street between West Street and Miller Street
- Denison Street \*2 between Berry Street and Spring Street
- Little Spring Street from Berry Street to Spring Street
- Little Walker Street from Berry Street to Mount Street
- Miller Street \*3 between Falcon Street and Pacific Highway
- Mount Street between Arthur Street North and Cahill Expressway
- Ward Street from Berry Street

Notes:

1. Cross Berry Street via Walker Street.
2. Local access available from Spring Street to Denison Street. No access to Berry Street from Denison Street.
3. Cross Miller Street via Ridge Street and McLaren Street from 4am to 6am and from 9am to 11am.

#### **SYDNEY CBD**

*From 4am to 11am*

- Cahill Expressway between Bradfield Highway and Conservatorium Road
- Conservatorium Road between Macquarie Street and Cahill Expressway on/off ramps
- Grosvenor Street between Lang Street and York Street (westbound)

#### **SYDNEY CBD / THE ROCKS / MILLERS POINT**

*From 4am to 11am*

- Argyle Place \*1 between Kent Street and Bettington Street (westbound)
- Argyle Street between Lower Fort Street and Kent Street (westbound)

- Dalgety Road between Bettington Street and Towns Place (westbound)
- Hickson Road \*2 between Towns Place and Napoleon Street (southbound)
- Napoleon Street \*3 between Kent Street and Sussex Street (westbound)
- Merriman Street\*1 from Bettington Street
- Rodens Lane \*1 from Bettington Street
- Sussex Street \*4 between Napoleon Street and King Street (southbound)
- Towns Place between Dalgety Road and Hickson Road (eastbound)
- Upper Fort Street \*5 between Watson Road and Sydney Observatory
- Watson Road \*5 between Upper Fort Street and Argyle Street

Notes:

1. Managed access to Bettington Street, Merriman Street and Rodens Lane via Dalgety Road southbound. No access to Argyle Place from High Street.
2. Local access to Hickson Road south of Towns Place managed by NSW Police.
3. Managed local access to Napoleon Street.
4. Cross Sussex Street via Erskine Street. Managed access to Slip Street via Erskine Street.
5. Managed local access to Observatory Hill under traffic control at Argyle Street and Watson Road.

**SYDNEY CBD / HAYMARKET / PYRMONT**

*From 4am to 11:30am*

- Darling Drive \*1 between Ultimo Road and Murray Street (northbound)
- Darling Drive\*1 between Murray Street and Pier Street (southbound)
- Harbour Street between Hay Street and Pier Street / Goulburn Street
- Harris Street \*2 north of Bowman Street (northbound)
- Hay Street between George Street and Harbour Street
- Murray Street between Darling Drive and Pirrama Road (northbound)
- Pier Street off ramp between Pier Street and Darling Drive
- Pirrama Road between Murray Street and Jones Bay Road (northbound)
- Pirrama Road \*3 between Jones Bay Road and Harris Street
- Sussex Street \*4 between King Street and Hay Street

Notes:

1. Darling Drive road closures managed by Lend Lease between Pier Street and Murray Street.
2. Local access to Harris Street north of Bowman Street will be managed by Police at Bowman Street.
3. Local access for Pirrama Road residents via Jones Bay Road under NSW Police control.
4. Managed access to Four Points by Sheraton hotel via Western Distributor - King Street off ramp.

## **2.2 LANE CLOSURES**

**SYDNEY HARBOUR BRIDGE and Cahill Expressway**

*From 4am to 11am*

- Sydney Harbour Bridge - Bradfield Highway (Lanes 3 and 6)
- Sydney Harbour Bridge - Bradfield Highway (Grosvenor Street on-ramp - northbound)
- Sydney Harbour Bridge - Bradfield Highway (Clarence Street on-ramp northbound)
- Sydney Harbour Bridge - Cahill Expressway (Lanes 7 and 8)
- Cahill Expressway (High Street on-ramp southbound)

- Cahill Expressway (Mount Street on-ramp southbound)

Sydney Harbour Bridge access:

- Lane 1 and lane 2 open northbound.
- Lane 4 and lane 5 open southbound.
- Access to Sydney Harbour Bridge from Sydney CBD via Kent Street and the Western Distributor.
- Access to Sydney Harbour Bridge from North Sydney via Arthur Street and the Mount Street on ramp.

## **2.3 SPECIAL EVENT CLEARWAYS**

### **NORTH SYDNEY**

*From 3am to 11am*

- Arthur Street between Pacific Highway and Mount Street (western side)
- Arthur Street between Mount Street and Berry Street (both sides)
- Berry Street between Miller Street and Arthur Street North (both sides)
- Miller Street between Blue Street and Berry Street (western side)
- Miller Street between Berry Street and Falcon Street (both sides)

### **SYDNEY CBD / HAYMARKET**

*From 3am to 11am*

- Dalgety Road between Argyle Place and Towns Place (western side)
- Erskine Street between Shelley Street and York Street (northern side)
- Sussex Street between Erskine Street and Hay Street (both sides)
- Sussex Street between Napoleon Street and Erskine Street (western side)
- Towns Place between Dalgety Road and Hickson Road (northern side)

### **ULTIMO**

*From 3am to 10am*

- Wattle Street between Thomas Street and Kelly Street (western side)

### **FIVE DOCK / CANADA BAY / CONCORD**

*From 5am to midday*

- Crane Street between Edith Avenue and Patterson Street (southern side)
- First Avenue between Arthur Street and Ingham Avenue (southern side)
- Lyons Road West between Udall Avenue and Edith Avenue (southern side)

# SPRING CYCLE - Road Closures & Special Event Clearways Sunday 18 October 2015 - North Sydney

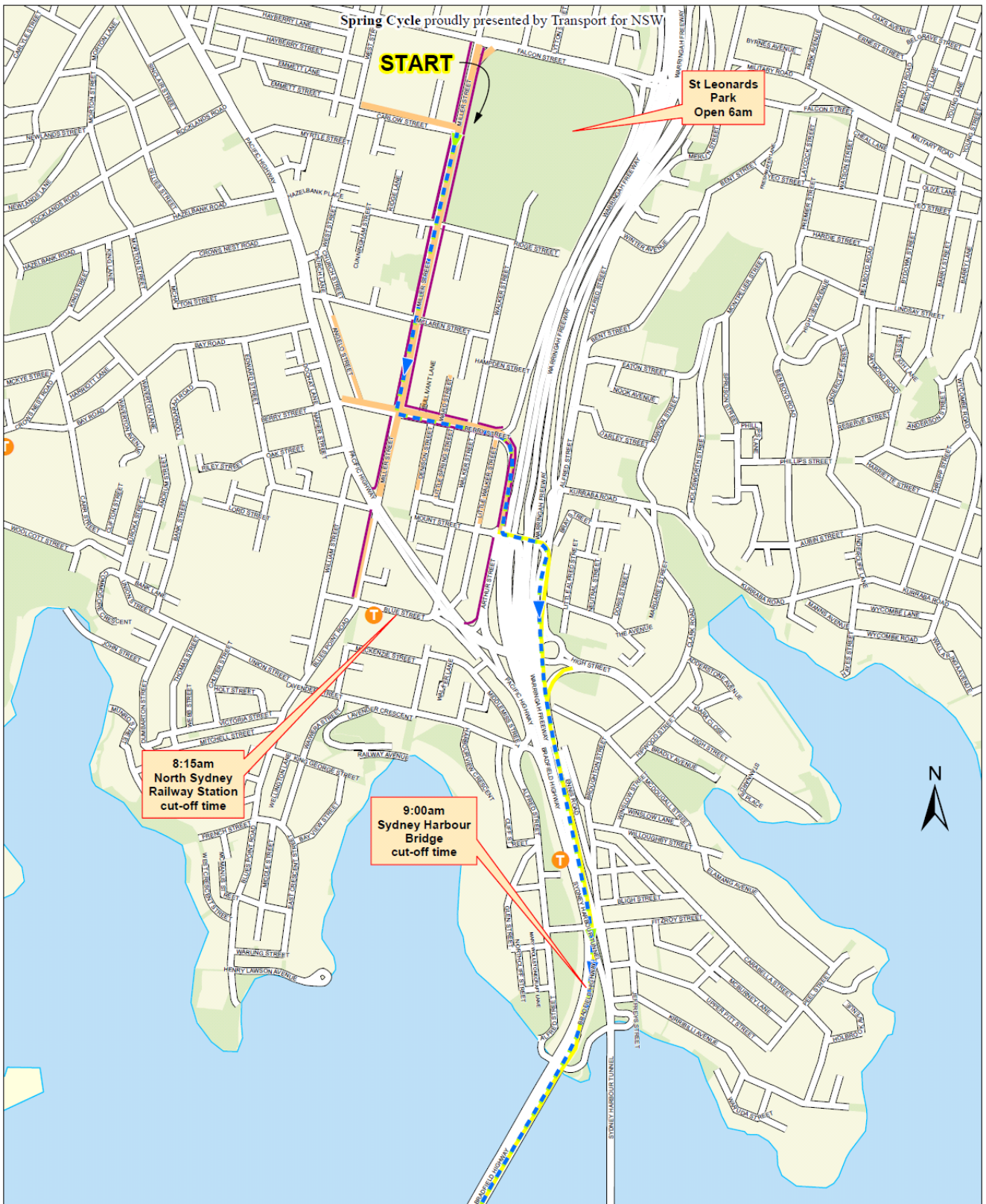

**Legend**

-  12km Ride Route
-  105km / 150km ride until Darling Drive
-  105km / 150km ride from Darling Drive to Sydney Olympic Park
-  Special Event Clearway 3am-11am
-  Road Closure 4am - 11am
-  Lane Closure 4am - 11am



0 0.1 0.2 0.3 0.4 0.5  
Kilometres

Map by Major Events Section, Transport Management Centre Eveleigh NSW.  
Base data © Copyright Department of Lands NSW 2014.  
Data issued: September 2015.  
File: \ARC\GIS\msd\SydneySpringCycle2015-NorthSydney-A3-internet.mxd

# SPRING CYCLE - Sunday 18 Oct 2015 Road Closures & Special Event Clearways

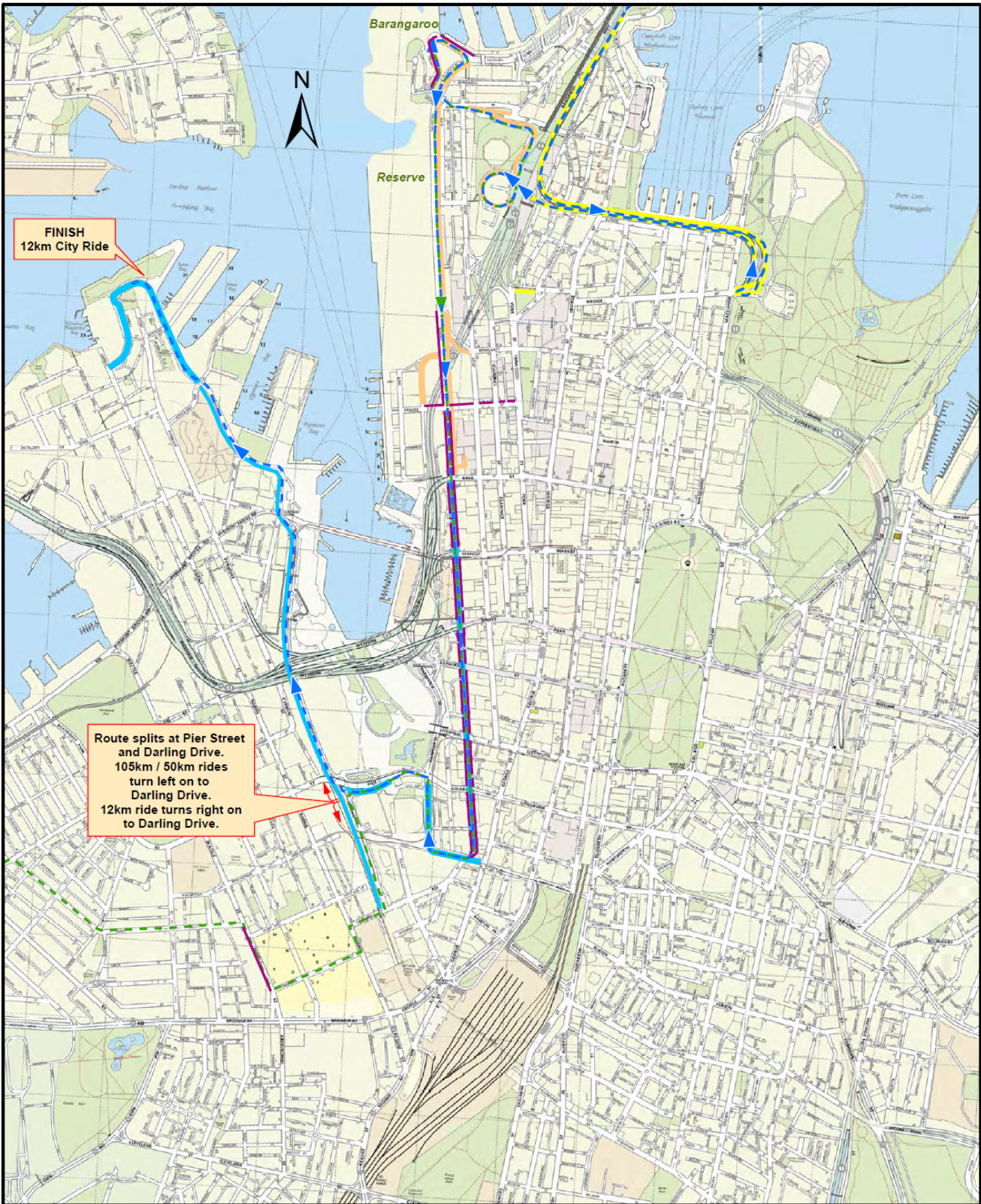

**Legend**

- ▶ 12km Ride Route
- ▶ 105km / 50km ride until Darling Drive
- ▶ 105km / 50km ride from Darling Drive to Sydney Olympic Park
- ▶ Special Event Clearway 3am - 11am
- Road Closure 4am - 11am
- Road Closure 4am - 11:30am
- Lane Closure 4am - 11am



0 50 100 200 300 400 500  
Metres

**Sydney** Copyright Melway Publishing 2010  
Reproduced from Sydney Edition 15 with permission

Map by Major Events Section, Transport Management Centre Eveleigh NSW.  
Base data © Copyright Melway Publishing 2014. Date Issued: September 2015  
File: \ArcGIS mxd\SydneySpringCycle2015-CBD\_Central-A3-internet.mxd

**SPRING CYCLE - Road Closures & Special Event Clearways  
Sunday 18 October 2015 - Pyrmont to Rhodes**

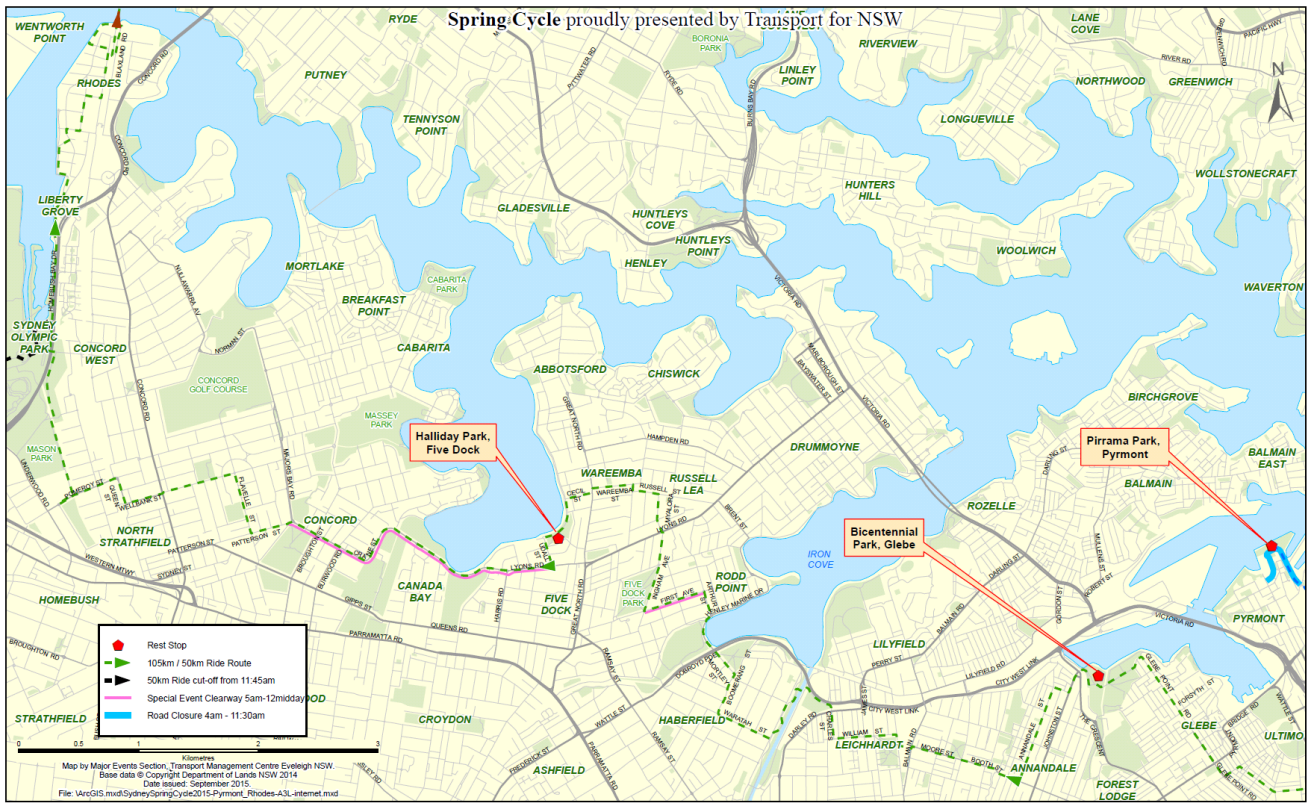

**SPRING CYCLE - Road Closures & Special Event Clearways  
Sunday 18 October 2015 - Rhodes to Sydney Olympic Park**

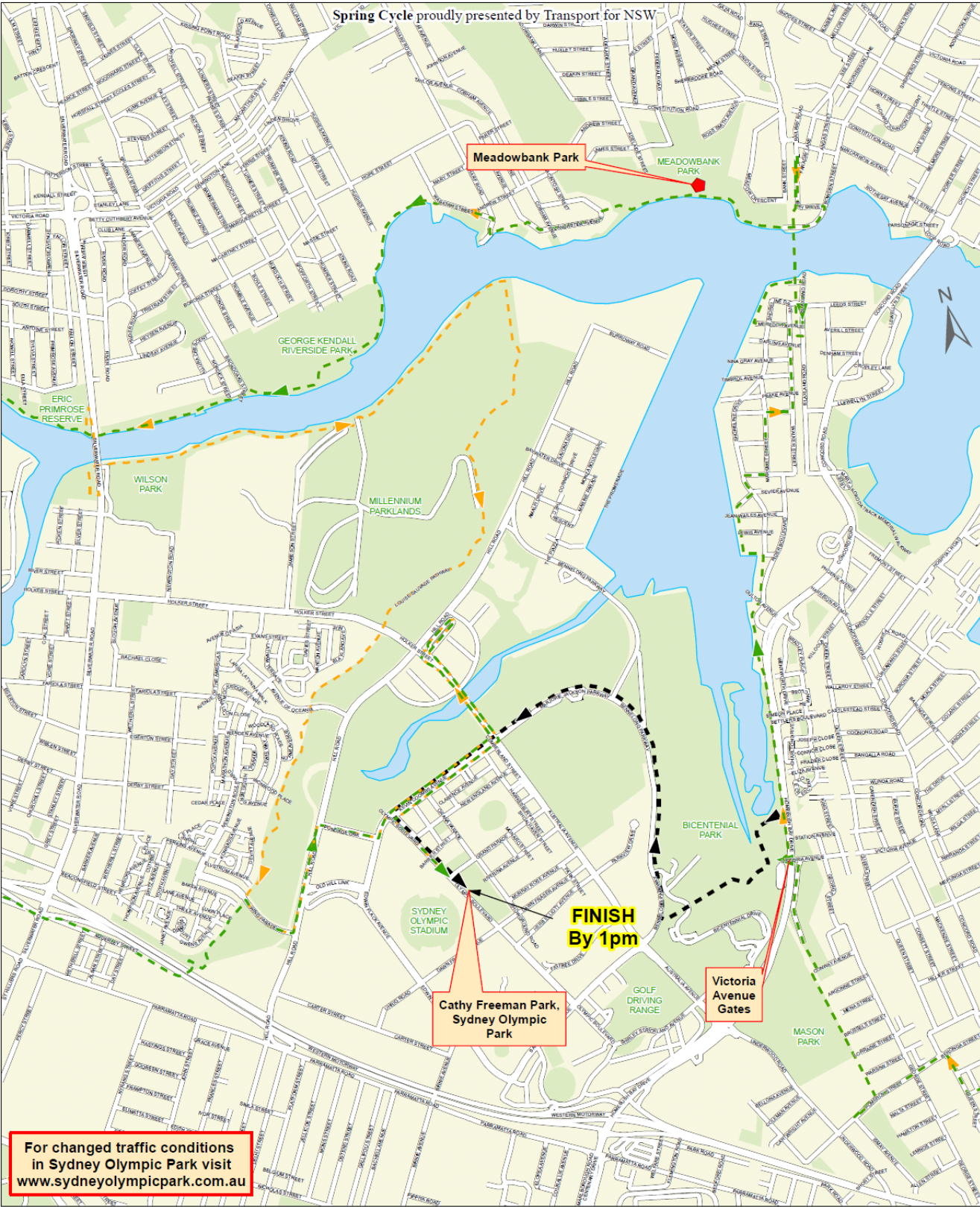

**Legend**

- 50km Ride Route
- 105km / 50km Ride Route
- 50km Ride cut-off from 11:45am
- Rest Stop



0 0.1 0.2 0.4 0.6 0.8 1  
Kilometres

Map by Major Events Section, Transport Management Centre Eveleigh NSW.  
Base data © Copyright Department of Lands NSW 2014.  
Date issued: September 2015.  
File: \ARCGIS mxd\GyneySpringCycle2015-Rhodes\_201P-A3-Internet.mxd



**SPRING CYCLE - Road Closures & Special Event Clearways**  
**Sunday 18 October 2015 - Rhodes to Wentworthville**

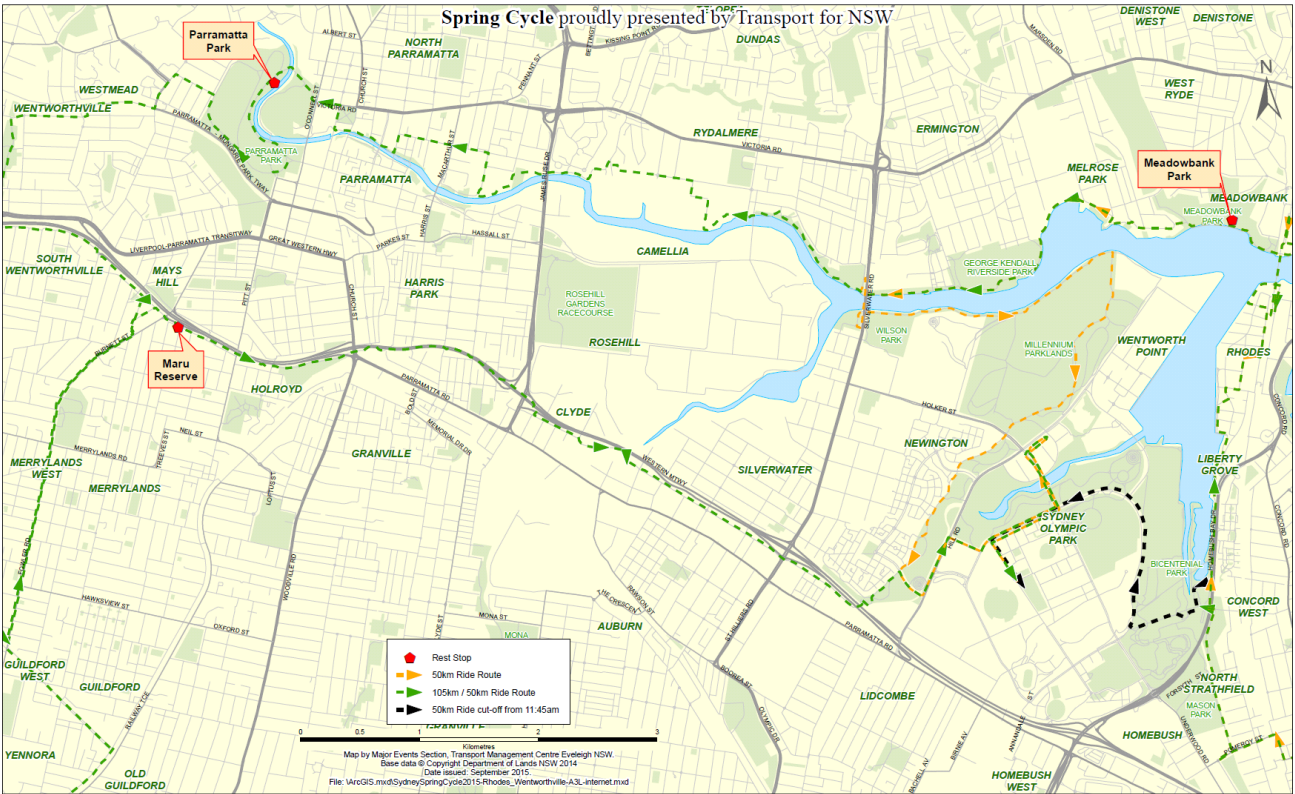

**SPRING CYCLE - Road Closures & Special Event Clearways**  
**Sunday 18 October 2015 - Wentworthville to Horsley Park**

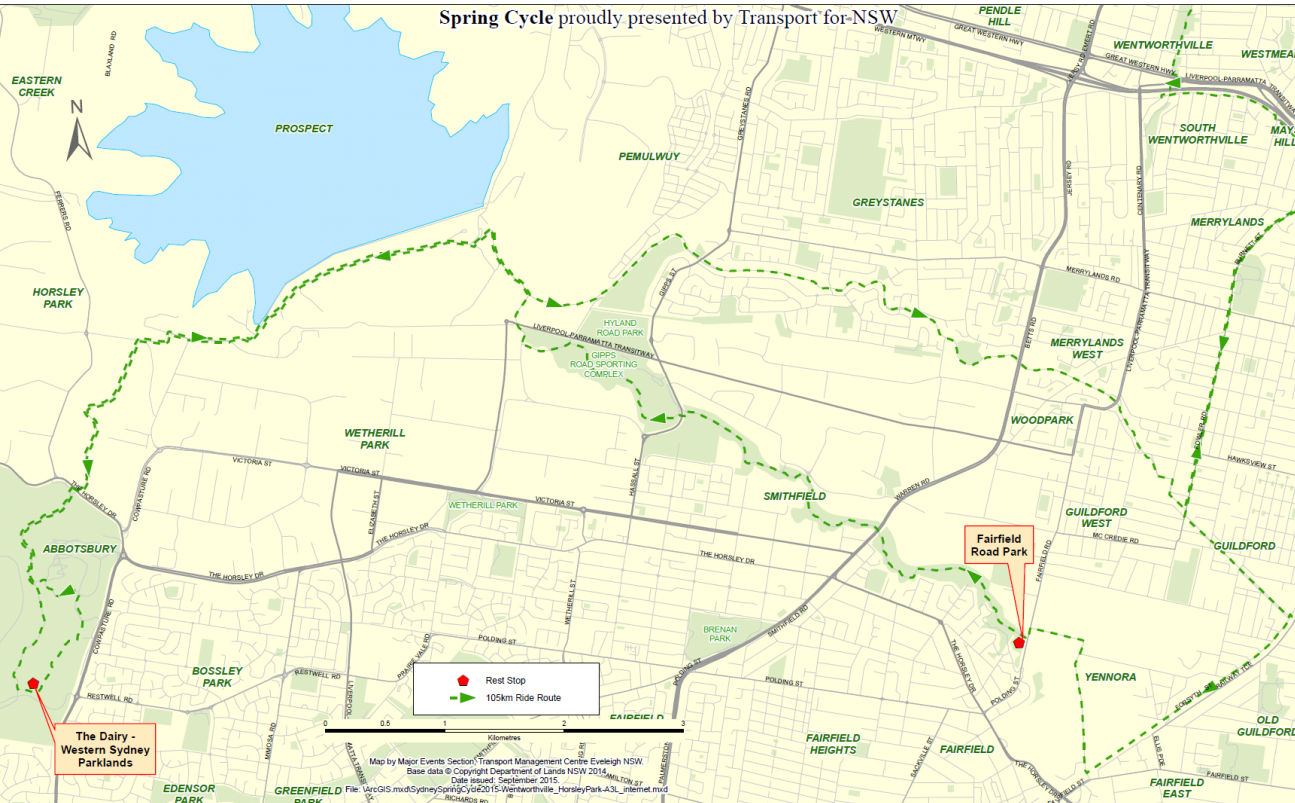

## **2. SPECIAL EVENT BUS ARRANGEMENTS**

No alteration to CBD terminals, however, due to large amounts of cyclists and for safety reasons State Transit buses are not to use **BLUE ST, NORTH SYDNEY** – passengers are to join services in the Pacific Highway adjacent to Greenwood Plaza.

Note to all Sydney Harbour Bridge **INBOUND** services: Lanes 6, 7 & 8 will be closed between 04:00 and 11:00.

Note: Pick up and set own as required at all stops along diversion route.

### **ALTS DUE TO BLUE ST CLOSURE**

#### **Routes 202, 207 & 208**

Inbound	Miller St, right Ernest St, left Alexander St, left Pacific Hwy, (use AGL Stop) left Arthur St North, right Mount St, then to the City via Bradfield Hwy (Harbour Bridge), left Grosvenor St, right George St, left Bridge St, left Phillip St to terminate Note : Harbour Bridge Lanes 6, 7 & 8 will be closed
Outbound	First Pick up Stand A(2000147), left Young St, right Bridge St, right George St, left Grosvenor St, left Lang St, right Jamison St, right Clarence St, as normal to Bradfield Hwy, left Pacific Hwy ( <b>DO NOT TURN INTO BLUE ST</b> ) right Alexander St, right Falcon St, left Miller St, then as normal

#### **Routes 288 & 292**

Inbound	As normal
Outbound	Erskin St, right York St, right Market St, right Clarence St then as normal

#### **Routes 252, 254, 290 & M20**

Inbound	Pacific Hwy, (use AGL Stop), left Arthur Street North, right Mount St, then to the City via Bradfield Hwy (Harbour Bridge) Note: Harbour Bridge Lanes 6, 7 & 8 will be closed
Outbound	As normal to Bradfield Hwy, left Pacific Hwy ( <b>DO NOT TURN INTO BLUE ST</b> ) then as normal

#### **Routes 263**

Inbound	Via High St, right Arthur St North, right Mount St, then to the City via Bradfield Hwy (Harbour Bridge) left Grosvenor St, right George St, left Bridge St, left Phillip St to terminate Note : Harbour Bridge Lanes 6, 7 & 8 will be closed
Outbound	First Pick up Stand A(2000147), left Young St, right Bridge St, right George St, left Grosvenor St, left Lang St, right Jamison St, right Clarence St to Bradfield Hwy, left Lavender St exit, Lavender St, right Blues Point Rd, Miller St, right Pacific Hwy (Use AGL Stop), then proceed straight ahead into High St overpass into High St, then as normal.

#### **Routes 151, 184, 190 and 247**

Inbound	Falcon St, left Alexander St, left Pacific Hwy (Use AGL Stop), left Arthur St North, right Mount St, then City via Bradfield Hwy (Harbour Bridge) Note : Harbour Bridge Lanes 6, 7 & 8 will be closed
Outbound	As normal to Bradfield Hwy, left Pacific Hwy ( <b>DO NOT TURN INTO BLUE ST</b> ), right Alexander St, right Falcon St, then as normal

**Routes 227 & 230**

Inbound	Falcon St, left Alexander St, left Pacific Hwy, right Miller St, Blues Point Rd then as normal
Outbound	Operate via normal to Pacific Hwy ( <b>DO NOT TURN INTO BLUE ST</b> ), right Alexander St(except for Pacific Hwy services), right Falcon St, then as normal

**Routes 311, 324 & 325**

Inbound	As normal to Kent St, left Erskine St, left Shelley St, right Cuthbert St, right Lime St and terminate
Outbound	Lime Street, right Erskine St, right York Rd then as timetabled

**Routes 343**

to Kingsford	Pacific Hwy, (use AGL Stop), left Arthur Street North, right Mount St, then to the City via Bradfield Hwy (Harbour Bridge) left Grosvenor St, right George St, left Bridge St, right Gresham St then as timetabled Note: Harbour Bridge Lanes 6, 7 & 8 will be closed
to Chatswood	As normal to Grosvenor St, left Lang St, right Jamison St, right Clarence St to Bradfield Hwy, left Pacific Hwy ( <b>DO NOT TURN INTO BLUE ST</b> ) then as normal

**Routes 389**

Inbound	Western Distributor take Pymont Bridge Rd exit, right Pymont Bridge Rd, left Banks St(underneath Western Distributor), right Miller St and Terminate near to Harris St
Outbound – to BJI	From Miller St, right Harris St, right Pymont Bridge Rd, left onto Western Distributor, then as timetabled

**Routes 441**

Routes 441 will be terminating and commencing from York Street QVB.

1<sup>st</sup> bus to arrive Art Gallery is at 11:06 (L030)

1<sup>st</sup> bus to depart Art Gallery is at 11:30 (L030)

**Destination Displays**

All services to display normal operating destinations regardless of changes to services or terminating services at Rail Interchanges



# Bus Route Diversions

Event: Sydney Cycle



Routes Affected

THE FOLLOWING DIVERSIONS APPLY BETWEEN 4.00AM AND 11.00AM.

- 202
- 203
- 207
- 208

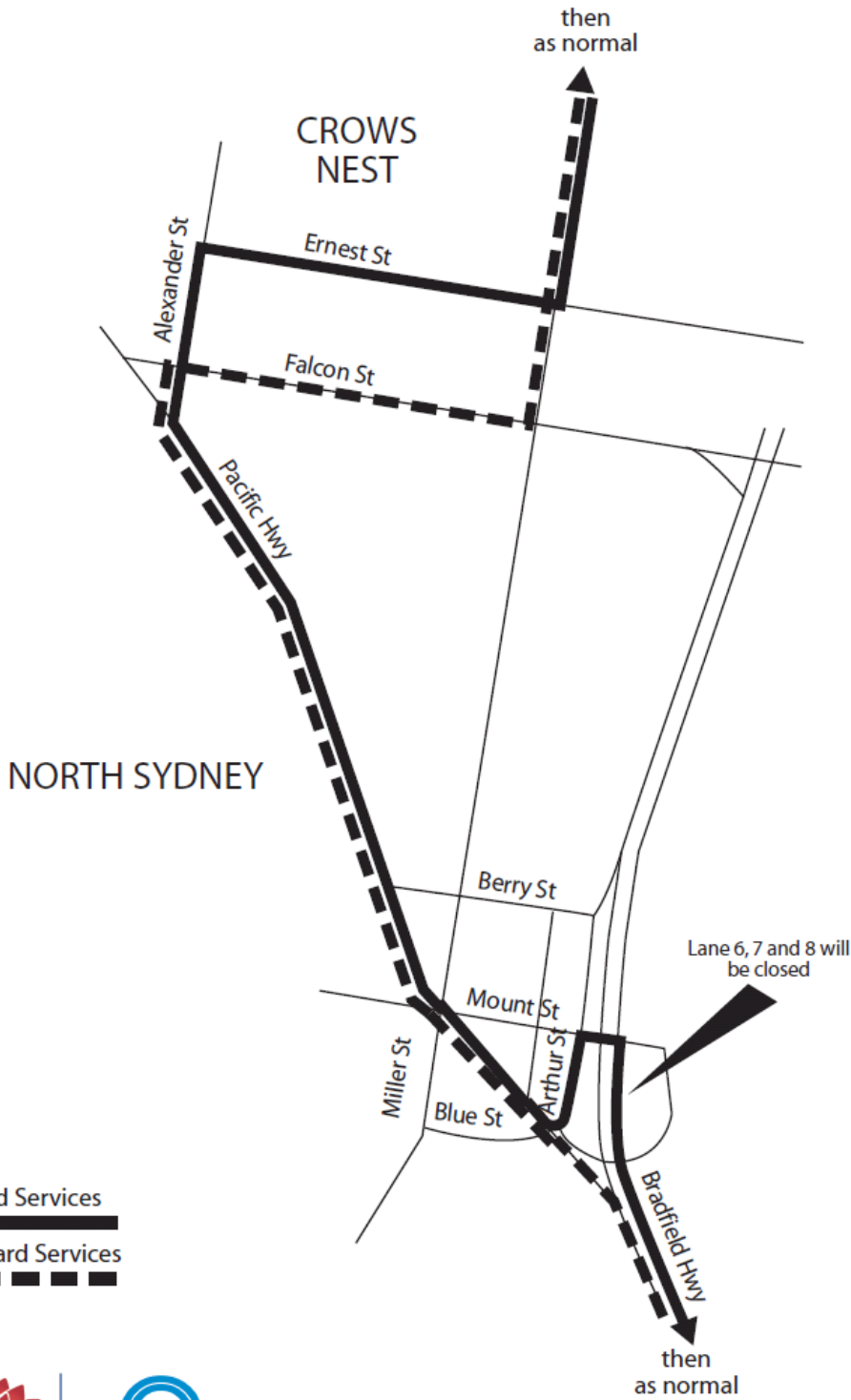

Please pick up and set down if required at all stops along the diversion route

Inward Services  
Outward Services





# Bus Route Diversions

Event: Sydney Cycle



North

Routes Affected

THE FOLLOWING DIVERSIONS APPLY BETWEEN 4.00AM AND 11.00AM.

263

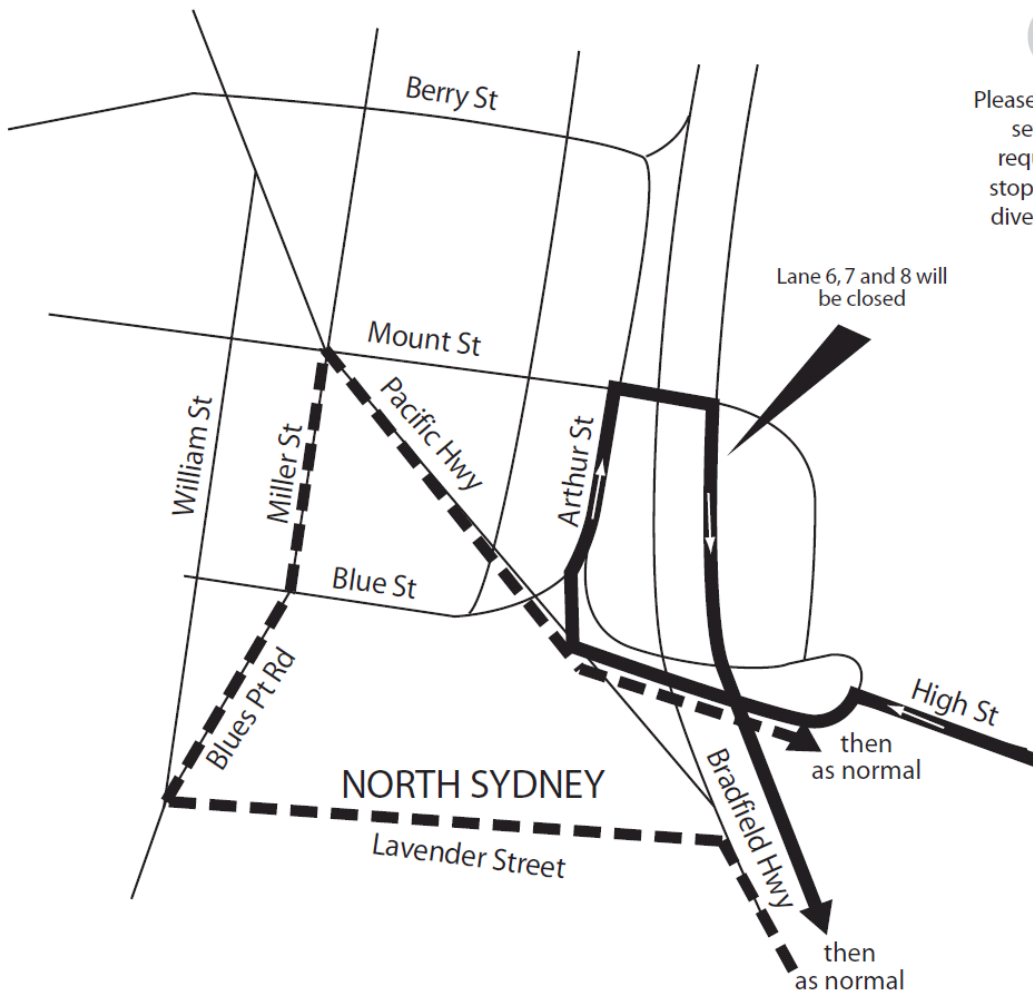

Please pick up and set down if required at all stops along the diversion route





# Bus Route Diversions

Event: Sydney Cycle



Routes Affected

THE FOLLOWING DIVERSIONS APPLY BETWEEN 4.00AM AND 11.00AM.

- 252
- 254
- 290
- 343
- M20



Please pick up and set down if required at all stops along the diversion route

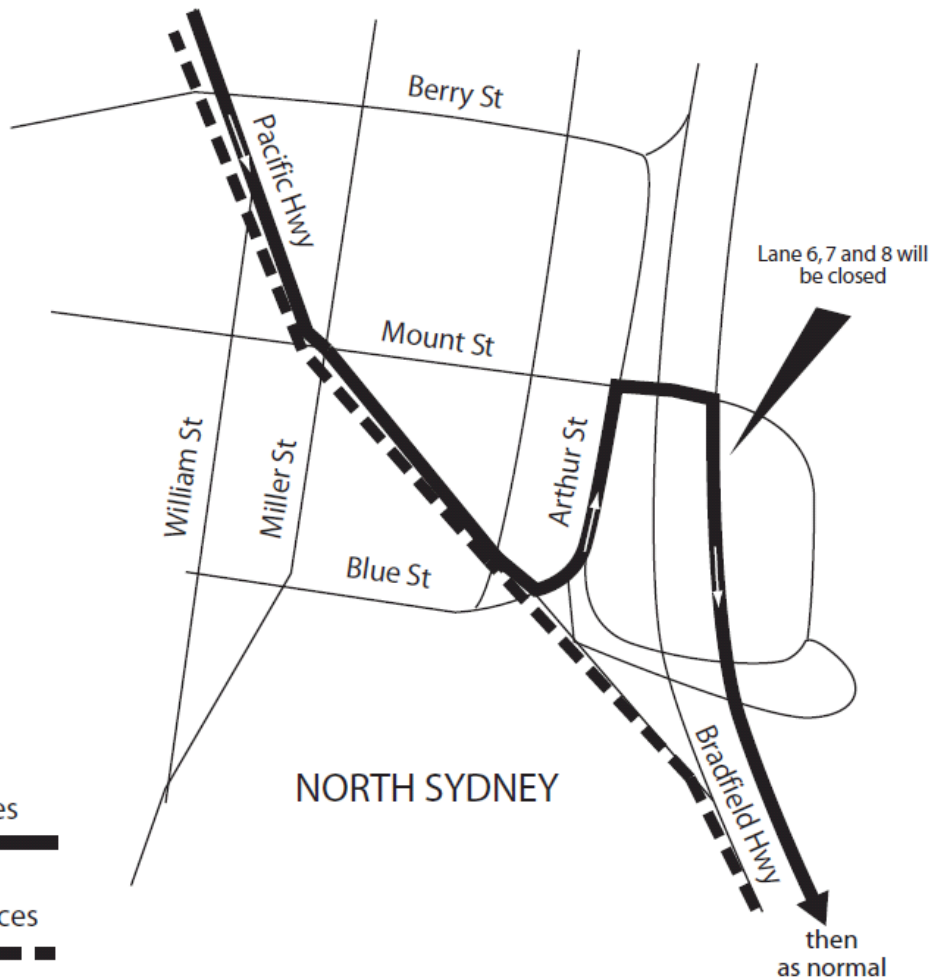

Inward Services



Outward Services





# Bus Route Diversions

Event: Sydney Cycle



North

Routes Affected

THE FOLLOWING DIVERSIONS APPLY BETWEEN 4.00AM AND 11.00AM.

- 151
- 184
- 190
- 247



Please pick up and set down if required at all stops along the diversion route

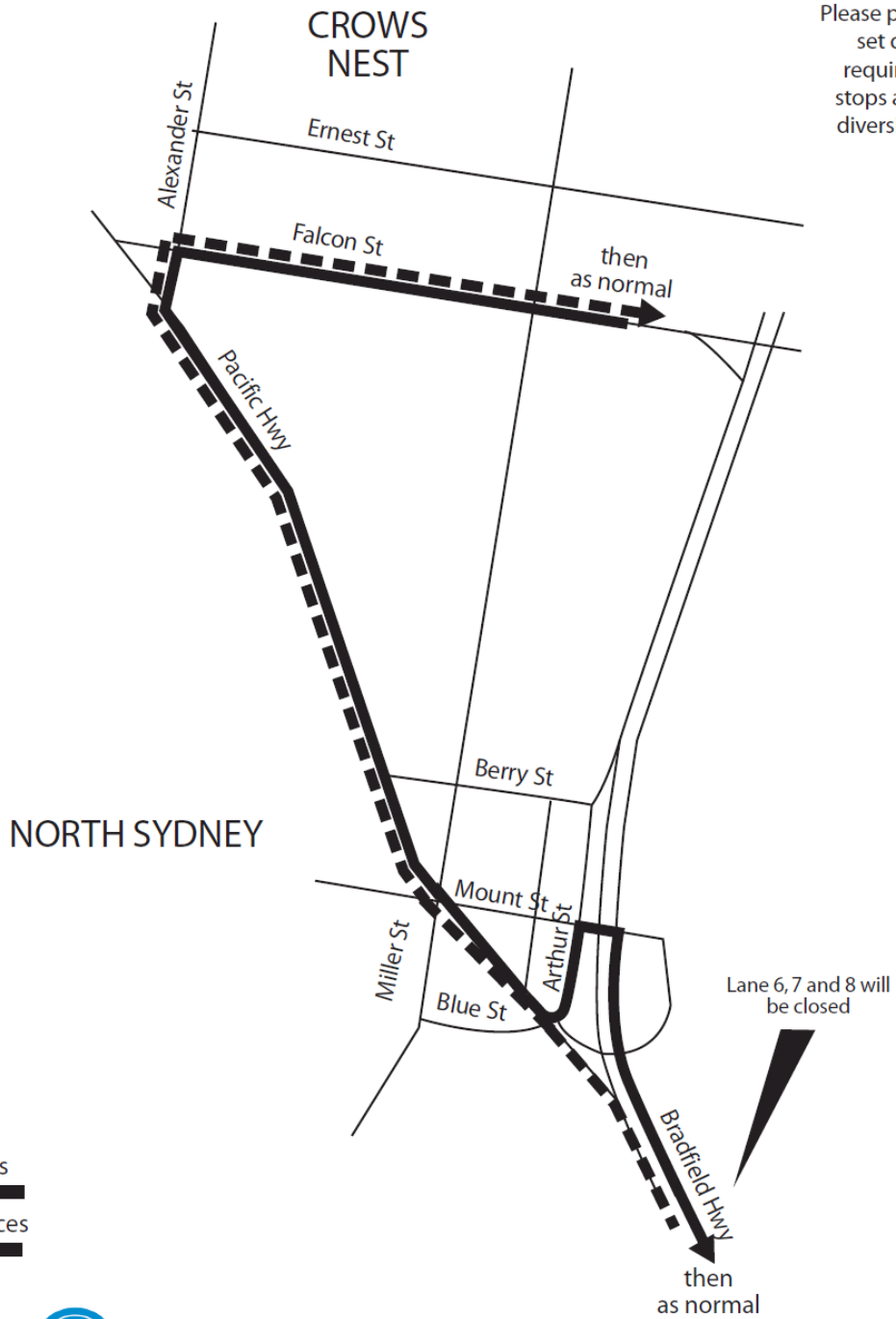

Inward Services  
Outward Services





# Bus Route Diversions

Event: Sydney Cycle



North

Routes Affected

THE FOLLOWING DIVERSIONS APPLY BETWEEN 4.00AM AND 11.00AM.

227

230



Please pick up and set down if required at all stops along the diversion route

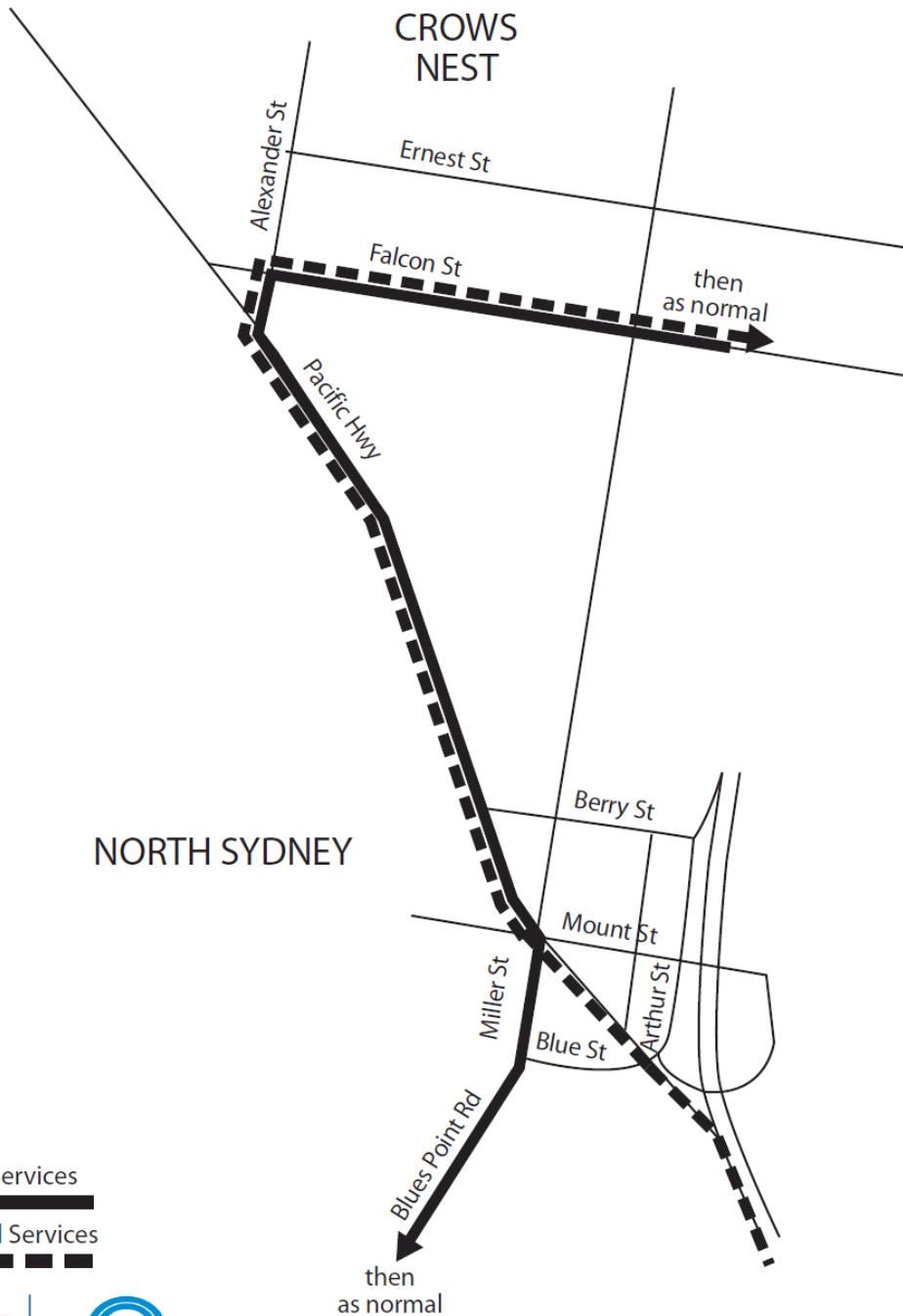

Inward Services  
Outward Services







# Bus Terminus Arrangements

Event: Spring Cycle



Routes

Affected

441

THESE TEMPORARY TERMINAL ARRANGEMENTS ARE IN OPERATION FROM FIRST SERVICE OF THE DAY UNTIL:

1st bus to arrive Art Gallery is at 11:06 (L134)

1st bus to depart Art Gallery is at 11:29 (L134)

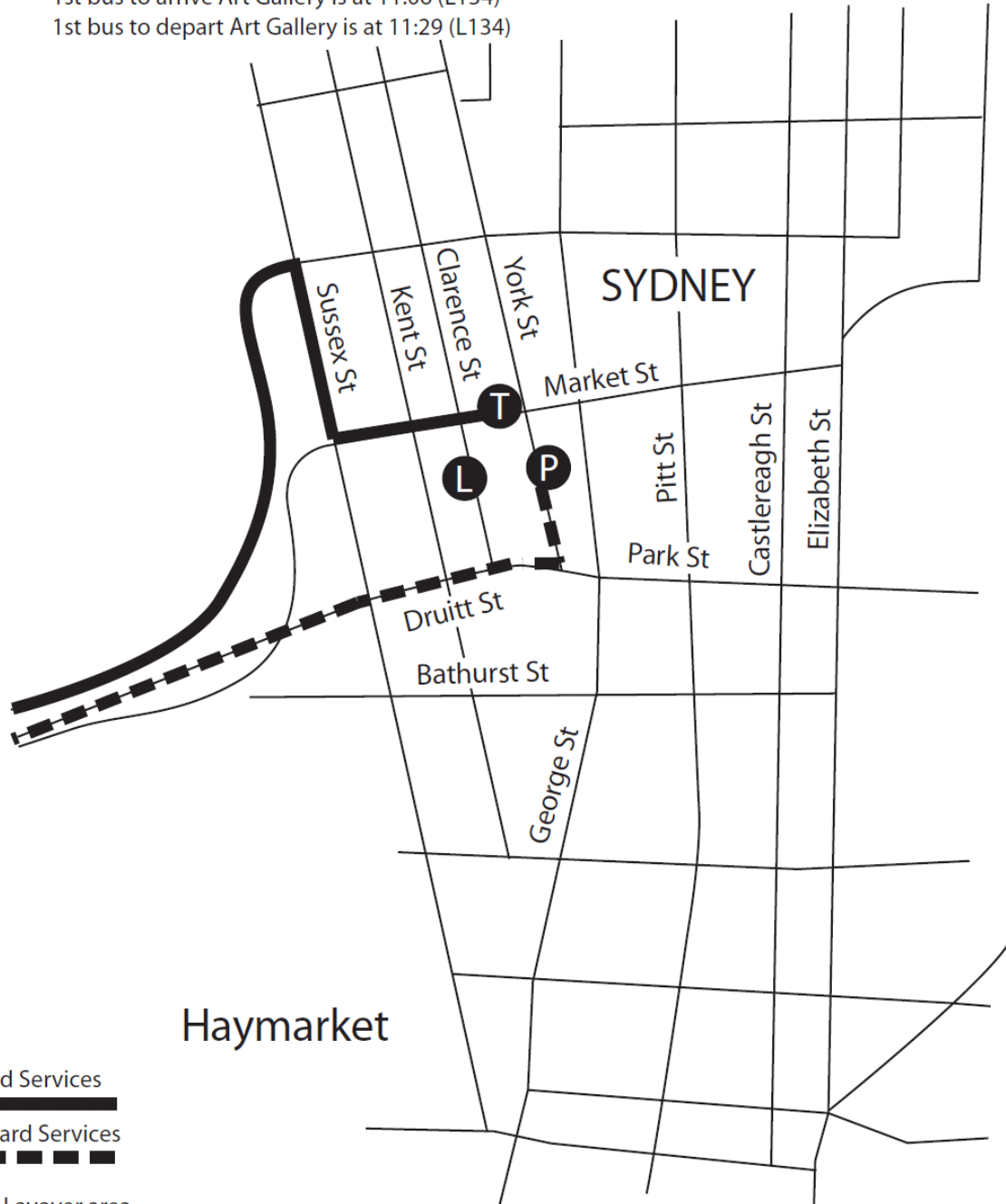

Inward Services

Outward Services

**L** Layover area

**P** First pick up point





# Bus Route Diversions

Event: Sydney Cycle



Routes Affected

THE FOLLOWING DIVERSIONS APPLY BETWEEN 4.00AM AND 11.00AM.

311  
324  
325



Please pick up and set down if required at all stops along the diversion route

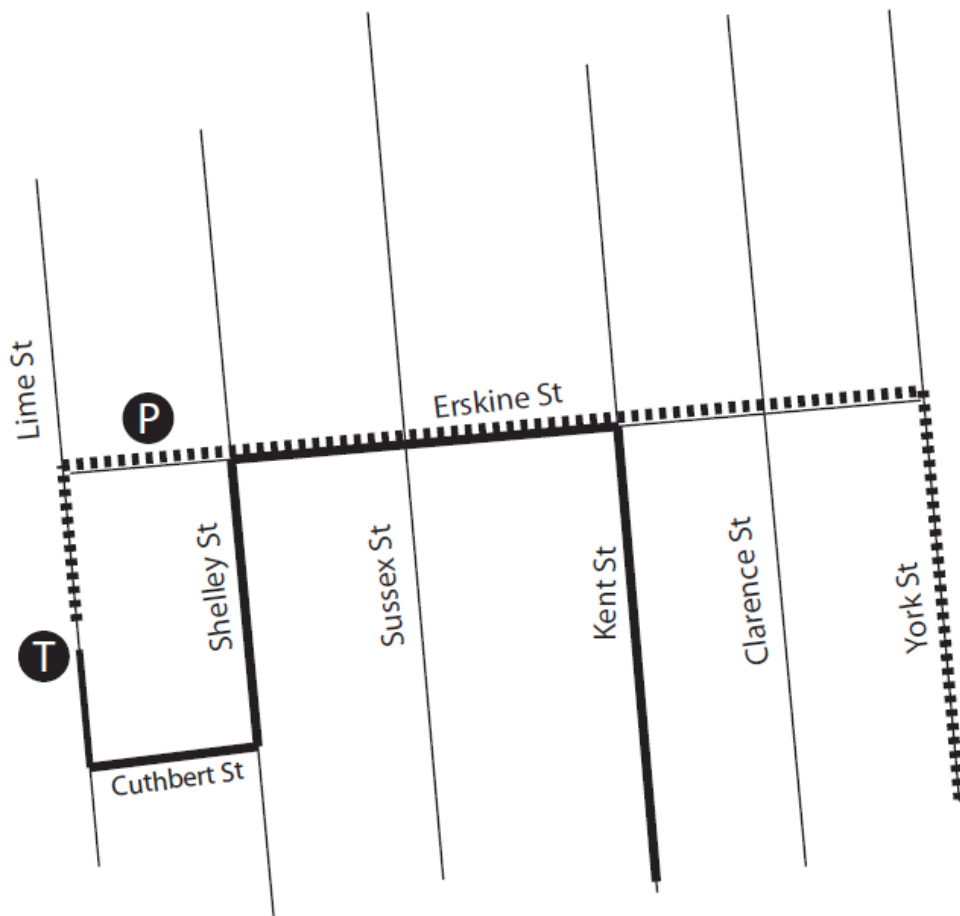

Inward Services



Outward Services



**P** First Pick Up

**T** Terminate





# Bus Route Diversions

Event: Sydney Cycle



Routes Affected

THE FOLLOWING DIVERSIONS APPLY BETWEEN 4.00AM AND 11.00AM.

343

Please see Northern Map for North Sydney Diversion



Please pick up and set down if required at all stops along the diversion route

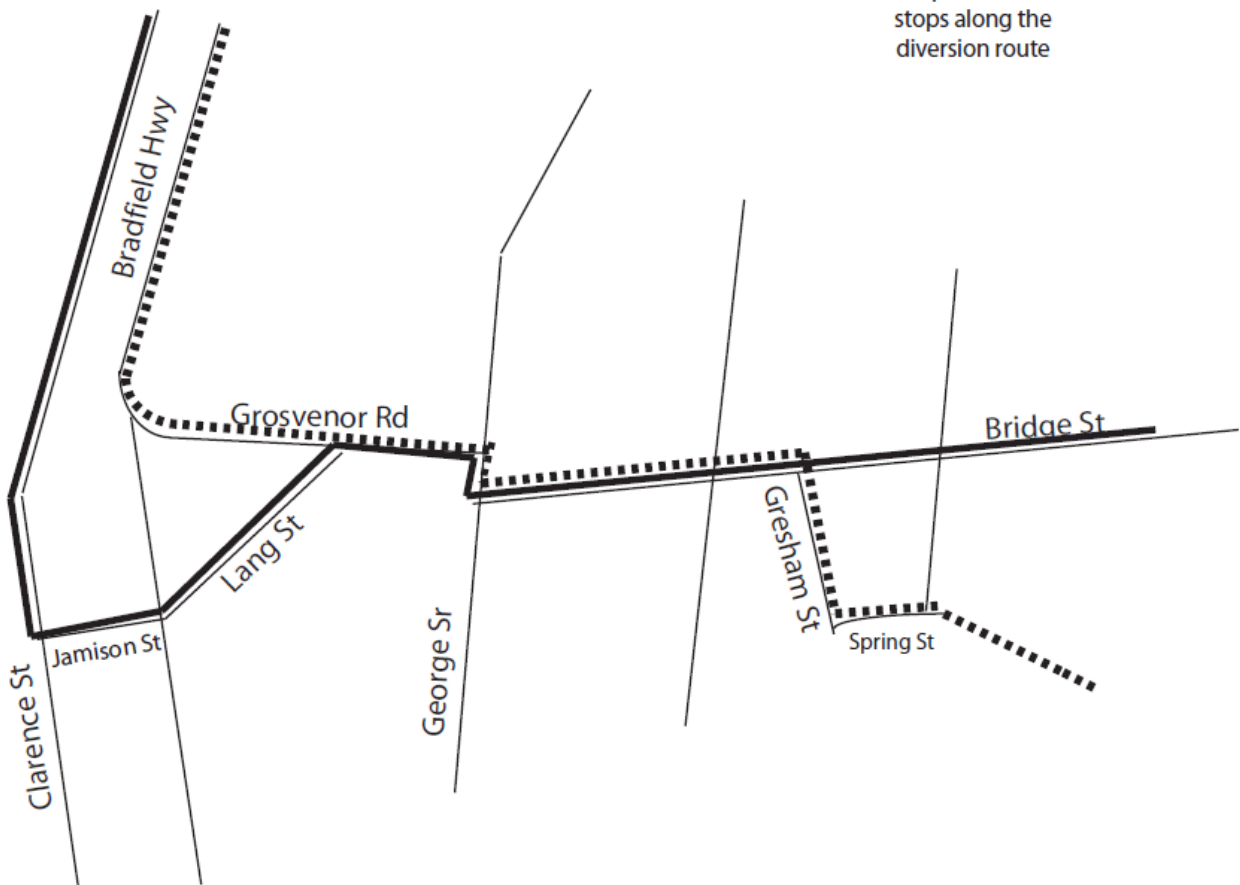

Inward Services to Chatswood

Outward Services to Kingsford





# SPECIAL EVENT - DIVERSION INFORMATION

Event: Spring Cycle

Route 389 diversion as directed

## Routes

389

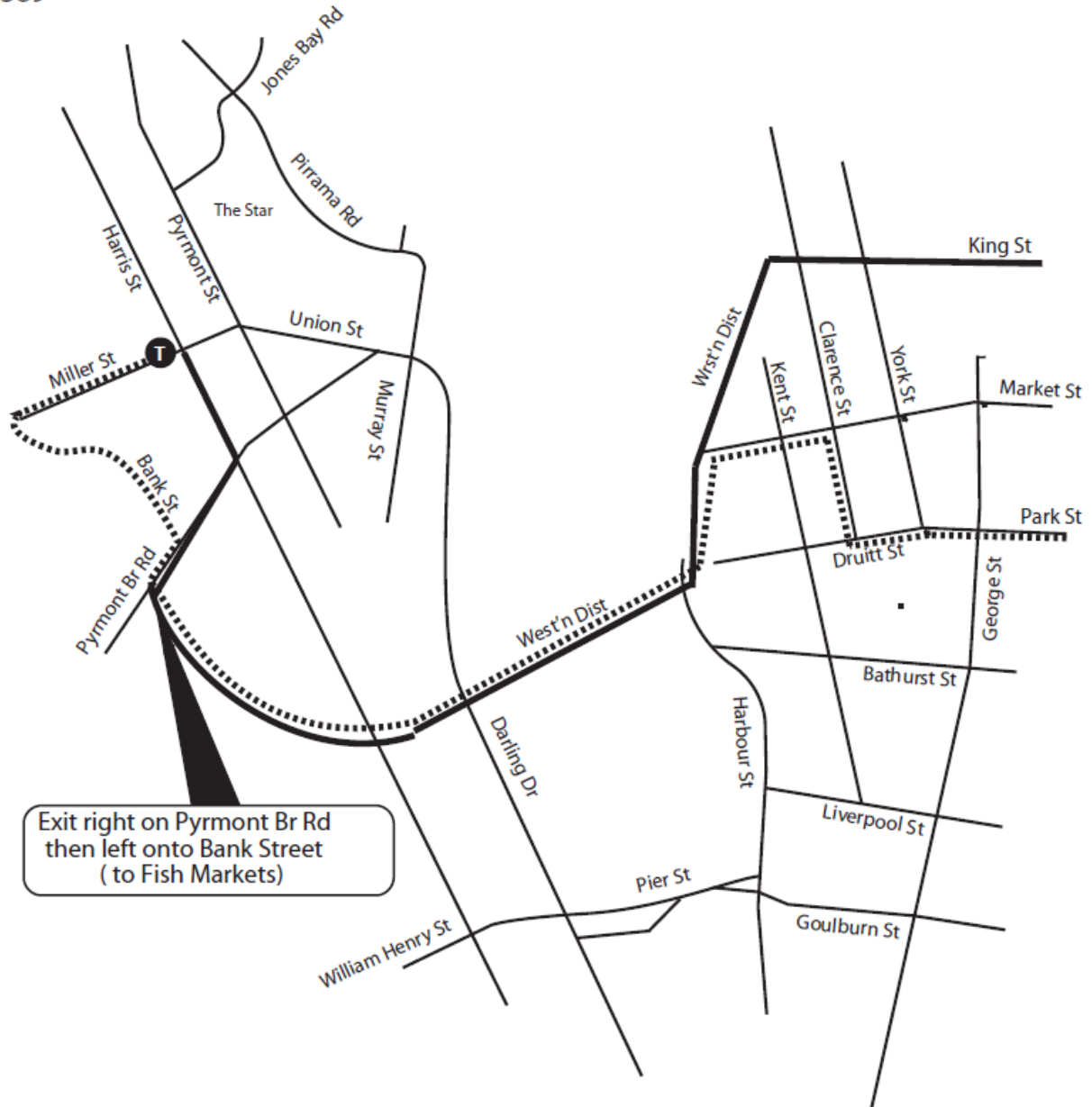

### Legend:



Terminus



To Maritime Museum



To BJI



Transport  
Sydney Buses

**3. EVENT SUPERVISION ROSTER**

SHIFTS				
Location	Officer	SCH	Times	Comments
West 25	Steve Harris	WAM	04:00 – 14:00	OIC Place signage along closed stops in Miller and Blue Streets routinely monitor area and ensure buses divert
Blue St (North 25)	TBC?	NAM	04:00 – 14:00	Way finding and Customer Service Ensure that passengers join services in Pacific Hwy
City 25	Ayman Beshay Alan Durban Mick Katsilieris	17 OCT TR11 TR22 TR23	Normal Times	Routinely monitor area, especially the Rocks area for congestion and divert services if required. Also routinely monitor Pyrmont for congestion and divert services if required
South 25	Bruno Sinatambou	SAM	07:00 – 15:00	Routinely monitor Canada Bay/ Five Dock/ SOP Precincts and divert services if required